

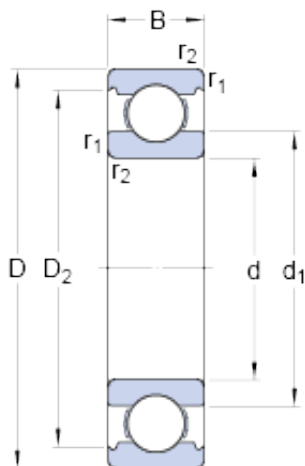

## Bearing de Mexico, S.A.

18 mm x 24 mm x 4 mm SKF WBB1-8713 deep groove ball bearings

Bearing No. WBB1-8713



WBB1-8713 Bearing 2D drawings and 3D CAD models

Size	24x18x4 mm
Bore Diameter	18 mm
Outer Diameter	18 mm
Width	4 mm
d	18 mm
D	24 mm
B	4 mm
d <sub>1</sub>	19.75 mm
D <sub>2</sub>	21.9 mm
r <sub>1,2</sub> - min.	0.15 mm
d <sub>a</sub> - min.	19 mm
D <sub>a</sub> - max.	23 mm
r <sub>a</sub> - max.	0.15 mm
Basic dynamic load rating - C	0.806 kN
Basic static load rating - C <sub>0</sub>	0.63 kN
Fatigue load limit - P <sub>u</sub>	0.029 kN
Reference speed	56000 r/min
Limiting speed	36000 r/min
Calculation factor - k <sub>r</sub>	0.015
d <sub>1</sub>	19.75 mm
D <sub>2</sub>	21.9 mm
r <sub>1,2</sub> min.	0.15 mm
d <sub>a</sub> min.	19 mm
D <sub>a</sub> max.	23 mm



## Bearing de Mexico, S.A.

$r_a$ max.	0.15 mm
Basic dynamic load rating C	0.806 kN
Basic static load rating $C_0$	0.63 kN
Fatigue load limit $P_u$	0.029 kN
Calculation factor $k_r$	0.015
Calculation factor $f_0$	15.8